

2-Button Wireless Occupancy Sensor With Dimming

Overview

- Bluetooth® NLC Certified
- Passive Infrared (PIR) Occupancy Sensor
- Two Buttons
- Manual on/off (wireless)
- Conforms with DLC NLC5 Cybersecurity Standards
- Dim up/down (wireless)
- LED Status Indicator Light
- Mounts in any Standard Wall Box
- Color: White



Suitable for Indoor Use
Switch Plate Sold Separately

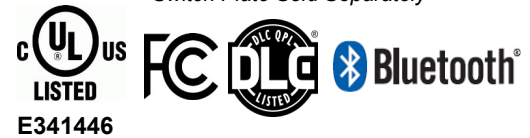

Applications

mwConnect's Wireless Occupancy Sensor Two Button Dimming Wall Controller (PSC-DM-I-WS-200-BLE-SR) provides automatic, occupancy-based lighting control for a variety of indoor applications. It can be mounted in any standard single-gang wall box.

The PSC-DM-I-WS-200-BLE-SR controls all of the lights in a specific zone. The unit also functions as a dimmer to override the pre-configured occupancy sensor settings.

PIR detection is best suited for areas with clear line of sight. Typical applications include classrooms, copy rooms, private offices, conference rooms, and private restrooms.

Operation

TruBlu™ Mesh: The PSC-DM-I-WS wall controller is a Bluetooth NLC certified device by the Bluetooth SIG and offers true multi-vendor interoperability. Configuration of the device and mesh network is accomplished via the TruBlu web portal or iOS mobile app. The app is used for initial setup and subsequent parameter adjustment.

Advanced functionality such as energy monitoring, and demand response is available with the TruBlu Gateway (ordered separately).

See TruBlu™ Commissioning User Manual for more information.

Summary

Sensor Type:
PIR Occupancy/Vacancy Sensor Dimmer

Input Voltage | Power Consumption:
120-277 VAC, 50/60Hz | Max 1.5W

Mounting:
Standard wall box

Max Range:
40 ft @ 4ft mounting height
(12.2m @ 1.2m mounting height)

Max Bluetooth Range¹:
30ft (9.14m)

Operating Temperature:
0° to 55°C

Storage Temperature:
-10° to 60°C

Relative Humidity:
90-95% non-condensing at 30°C

Color: White

Warranty: 5 years

Note:
1. Bluetooth Range is highly dependent on the integration of fixtures, surrounding environment and conditions. It is recommended to conduct testing for range accuracy.

Project

Location/Type

Physical Dimensions

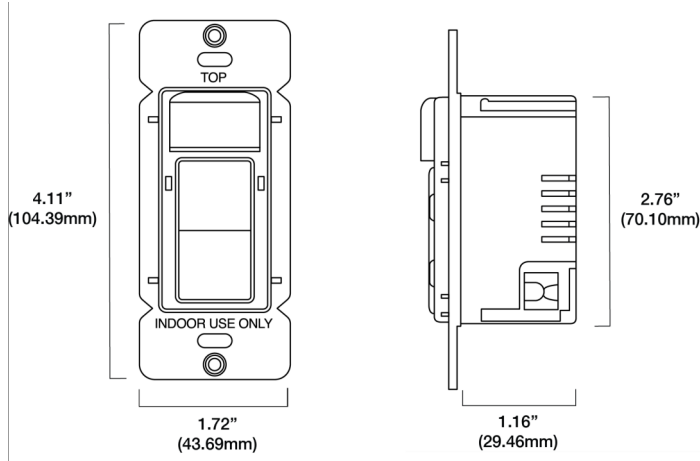

Wiring Diagram

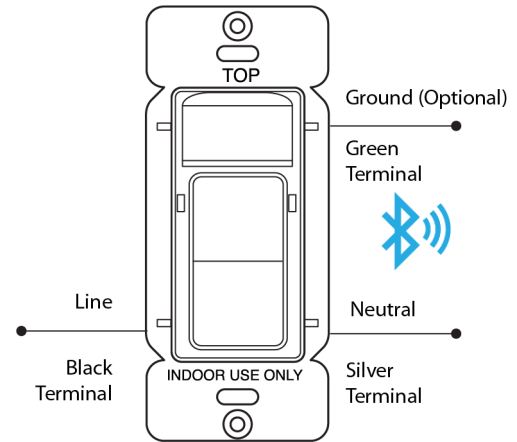

Example

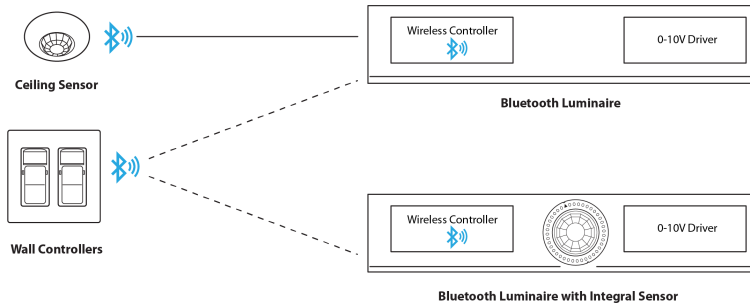

Detection Area

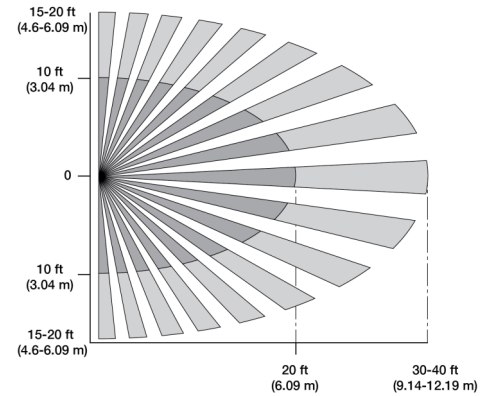

Drawings are not to scale

Wireless Manual Control

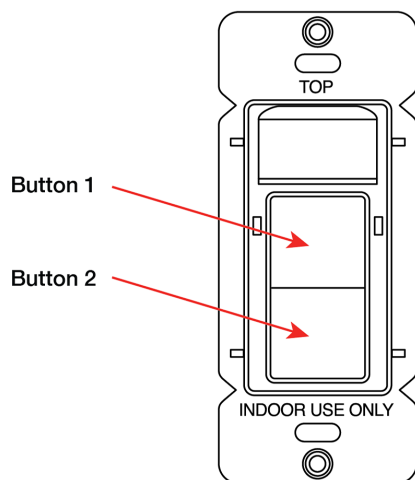

On/Off Control

Button 1 for On:

Short press - ON/Auto*

Button 2 for Off:

Short press - OFF

*Auto = Resume automatic control; turns on the automatic settings for luminaires (defined by the settings profile).

For Dimming:

Button 1 for Raise:

Press and Hold - RAISE

Button 2 for Lower:

Press and Hold - Lower

Factory reset:

Hold both Button 1 and Button 2 for 10 sec. The device returns to an un-provisioned state.

How to Order

| Model No. | Description | Input Voltage |
|------------------------|----------------------------------------------------------------------------------------------------------------------------------------------------|-------------------|
| PSC-DM-I-WS-200-BLE-SR | Wireless PIR Occupancy Sensor Two Button Dimming Wall Controller, TruBlu Bluetooth Mesh, Silvalr Technology partner (decorator plate not included) | 120-277 VAC, 60Hz |

Design and specifications are subject to change without notice.